



DATE RECEIVED _____

PERMIT # _____

Bringing in-depth code analysis to today's built environment

Andy Schreder CBO Email: andy@rumrivercc.com Cell: 763-291-3704

ATHENS TOWNSHIP DECK PERMIT APPLICATION

NOTICE: THIS IS AN APPLICATION ONLY. PERMIT WILL BE ISSUED AFTER APPROVAL AND PAYMENT OF FEES. WORK IS NOT AUTHORIZED TO BEGIN PRIOR TO ISSUANCE. ~ SUBMIT APPLICATION TO: RUM RIVER CONSTRUCTION CONSULTANTS AT EMAIL ADDRESS ABOVE.

APPLICANT IS THE: OWNER CONTRACTOR

SITE ADDRESS: _____

PROPERTY OWNER NAME _____

ADDRESS _____ CITY _____ STATE/ZIP _____

PHONE # _____ EMAIL _____

CONTRACTOR NAME _____

ADDRESS _____ CITY _____ STATE/ZIP _____

PHONE # _____ EMAIL _____

CONTRACTOR STATE LICENSE #: _____

LEAD CERTIFIED FIRM #: _____

CONTACT NAME: _____ PHONE: _____

DESCRIPTION OF WORK: _____

VALUATION (LABOR & MATERIALS): \$ _____

The undersigned acknowledges that he/she has read this application and the above information is correct and accurate. Applicant also understands by signing this application that he/she could be held responsible as representative of this project for any violation of compliance with all applicable laws and ordinances of the ruling jurisdiction.

APPLICANT SIGNATURE _____ PRINTED NAME _____

DATE _____ ***I HAVE READ, COMPLETED AND WILL RETURN BOTH SIDES OF THIS APPLICATION**

OFFICE USE ONLY

DATE PAID _____ PAYMENT INFO _____ RECEIVED BY _____

ENGINEERING _____ DATE _____ ENGINEERING FEE: \$ _____

PLANNING _____ DATE _____ ZONING FEE: \$ _____

BUILDING _____ DATE _____ PLAN REVIEW FEE: \$ _____

PERMIT FEE: \$ _____

SURCHARGE FEE: \$ _____

TOTAL FEES: \$ _____

DECK PLAN DETAILS APPLICATION CHECKLIST

ADDRESS _____ CITY _____ STATE & ZIP: _____

YES NO

- ___ ___ 1. Is a future porch being considered?
- ___ ___ 2. Will there be a hot tub or spa on the deck?
- ___ ___ 3. Is the deck attached to a house cantilever? If yes, provide special design.
- ___ ___ 4. Is a guardrail required (over 30 inches above grade)?
- ___ ___ 5. Is a handrail required on the stairs (4 or more risers)?
- ___ ___ 6. Does the deck site plan show the distance to the property lines and buildings?
- ___ ___ 7. Using composite deck materials? If yes, identify: _____.

DECK WIDTH _____ BEAM SIZE _____ POST SIZE _____ POST SPACING _____

JOIST LENGTH _____ JOIST SIZE _____ JOIST SPACING _____ NUMBER OF POSTS _____

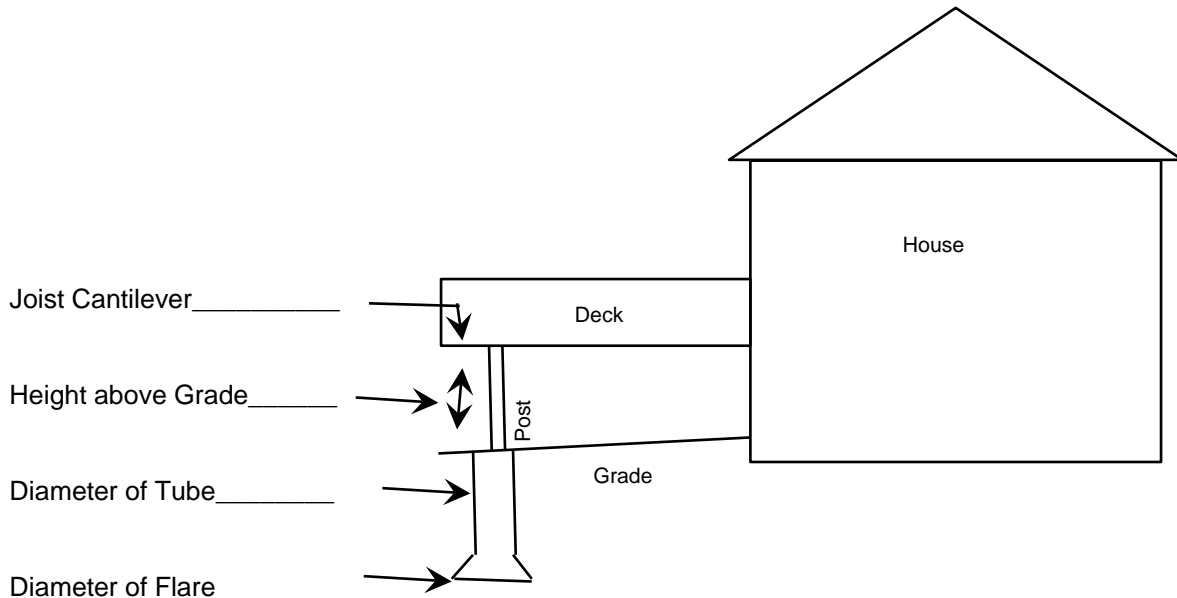

Ledger Board: Must be at least the same size as deck floor joists. Install lag screws or other approved anchors that penetrate 1 ½ inches into rim joist or wall studs. Where proper anchoring/support cannot be verified, a self-supporting deck will be required. Placement of lag screws to meet Table {R507.2.1(1)}

Document what you are attaching the ledger board to and what type of screw along with the spacing plan:

___ Dimensional Lumber Rim Board ___ Engineered Wood Rim Board ___ Floor Trusses

Specify fastener type, length and spacing: _____

If ledger is attached to floor trusses, specify truss spacing: _____

Residential Decks Information Sheet

Building Permits

Building permits are required for all decks that are attached to the home or more than 30 inches above grade. A building permit must be issued prior to construction. It is necessary to allow 5-10 business days for review before the permit is ready to be picked up. With your permit, you will be given a copy of the approved plan which must be kept on site for inspections. Please be aware that changes to your plan must also be approved prior to scheduling an inspection.

Plan Submittal

Site plan showing deck size and location;
one copy of the building plans showing construction details including footing size, framing material size and spacing, decking material.

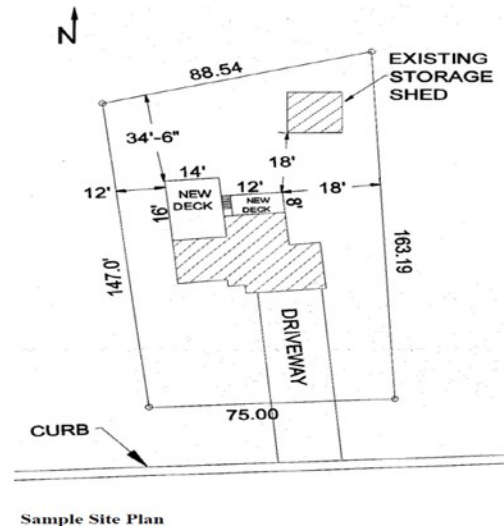

Frost footings

Required for any deck attached to a dwelling, porch or garage that has frost footings. The minimum depth to the base of the footing is 42 inches.

Structural Design

All decks shall be designed to support a live load of 40 pounds and a dead load of 10 pounds per square foot minimum.

Fasteners

All nails, screws and other connectors must be hot-dipped galvanized, stainless steel or of other approved corrosion resistance. Note: If joist hangers are stainless steel, the nails in contact with hangers must be of the same material. The same would apply to any galvanized products.

Wood Required

All exposed wood is required to be naturally resistant to decay (redwood, cedar, etc.) or approved treated wood. This includes posts, beams, joists, decking and railings. Cedar or redwood posts need an eight (8) inch separation from the ground. **Composite or plastic decking materials must be approved prior to installation.**

Lateral Loads

Hold-down tension devices shall be installed at two locations per deck, each device to have allowable stress design capacity not less than 1500 pounds. {R507.2.3}. We have also been accepting 4 connections worth 750#.

Ledger Board

Must be at least the same size as deck floor joists. Install lag screws or other approved anchors that penetrate 1 ½ inches into rim joist or wall studs. Where proper anchoring/support cannot be verified, a self-supporting deck will be required. Placement of lag screws to meet Table {R507.2.1(1)}

Document what you are attaching the ledger board to and what type of screw along with the spacing plan:

___ Dimensional Lumber Rim Board ___ Engineered Wood Rim Board ___ Floor Trusses

Specify fastener type, length and spacing: _____

If ledger is attached to floor trusses, specify truss spacing: _____

Flashing

All connections between the deck and dwelling shall be flashed with an approved material. Any cuts or penetrations into the existing structure must be flashed in an approved manner. Uncoated aluminum shall not be used in contact with pressure preservative treated wood. This means the ledger flashing and other materials in contact with treated lumber shall be galvanized, stainless steel or vinyl.

Framing Details

Verify the following information is identified on the plans:

1. Joist size
2. Deck Joists: size and spacing
3. Direction of framing
4. Direction of decking
5. Beam Size/location
6. Posts
7. Footing size/location
8. Proposed lengths of cantilevers

Special Design Note

Some deck designs may not be suitable for a future screen or 3-season porch. Setbacks and structural support may vary. Please indicate on the site and building plans if future considerations include a porch. Loading requirements change for hot tubs, pavers and outdoor kitchens. These decks require an engineered design.

Stairs

2 x 12 stringers or special design required.

Minimum width is 36 inches. Maximum rise is 7-3/4 inches, minimum run is 10 inches. Largest tread width or riser height shall not exceed the smallest by more than 3/8 inch. Maximum 4 inch opening at risers for stairs to a platform greater than 30 inches in height.

Guard rails

Do not notch guard posts.

Required on all decks more than 30 inches above grade. Guard must be 36 inches minimum in height. Open guards must have intermediate rails or an ornamental pattern where a four-inch sphere cannot pass through.

Handrails at Stairs

Required for stairs with 4 or more risers, 34 to 38 inches in height and measured from the nosing of the stair. Ends shall be returned or terminated at the top and bottom. All required handrails shall be continuous for the full length of the stairs from a point directly above the top riser of the flight to a point directly above the lowest riser of the flight. Handrail end shall be returned to posts.

Required Inspections

1. Footing – after the holes are dug, but prior to placing concrete.
2. Framing – to be done after all framing, blocking and required hardware are in place. This inspection can be completed at the time of Final Inspection provided the deck is at least 3 feet above grade.
3. Final – after all decking, handrails and guardrails are in place and prior to use.

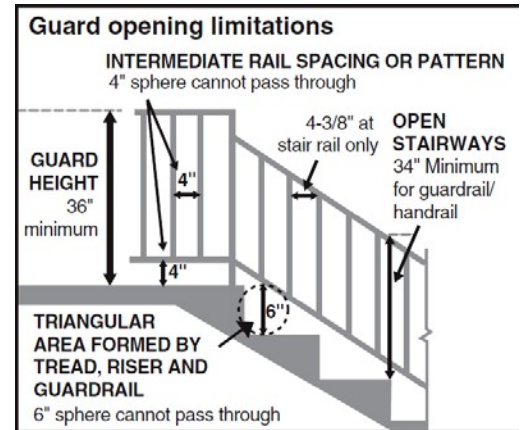

NOTE: 2-day minimum notice required for inspection.